

AC centrifugal blower

Dual inlet, forward curved



- **Impeller material:** Sendzimir galvanized sheet steel

- **Housing material:** Talcum-reinforced polypropylene, color: black (in accordance with IEC 695 T2-2 and EN 60335-2-31)

- **Mount:** Via 4 sheet-metal nuts (for threading according to EN ISO 1478-ST4.8), min. screw length 14.5 mm + thickness of mount material

| Nominal data | | Voltage | Frequency | Air flow | Speed | Power consumption | Current draw | Capacitor capacity | Sound pressure level | Operative range 50Hz | Ambient temperature 50Hz | Weight |
|--------------|----------|---------|-----------|-------------------|-------|-------------------|--------------|--------------------|----------------------|----------------------|--------------------------|--------|
| Type | Motor | 1 - VAC | Hz | m ³ /h | 1/min | W | A | uF/V | dB(A) | Pa | °C | kg |
| D2E146HT6702 | M2E068EC | 230 | 50 | 1060 | 1850 | 355 | 1.55 | 8.0 / 450 | 66 | 0 .. 490 | -25 .. 50 | 3.6 |

Subject to modification

Characteristic: Pressure over air flow at 50Hz

| n | P ₁ | I | LpA | ntL |
|---------|----------------|-----|-------|-----|
| [1/min] | [W] | [A] | [dBA] | [%] |

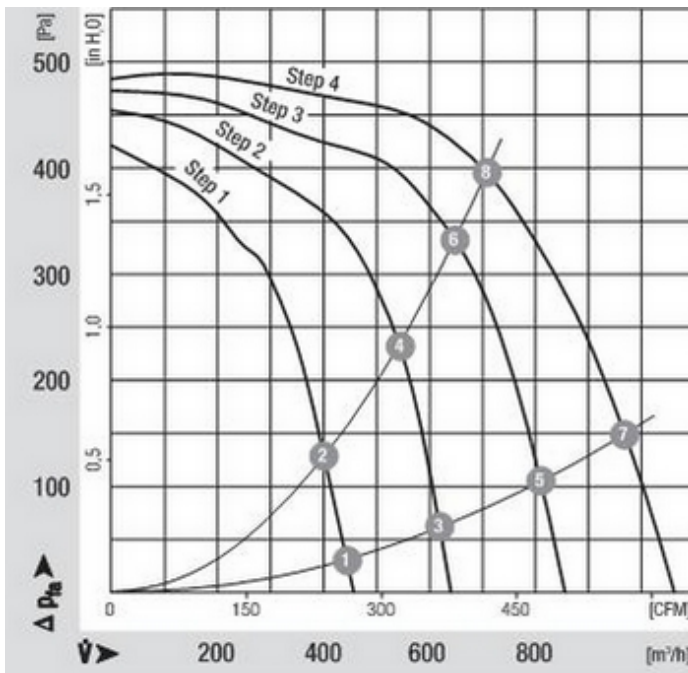

| | | | | | |
|---|------|-----|------|----|----|
| 1 | 1000 | 192 | 0,88 | -- | -- |
| 2 | 1415 | 180 | 0,84 | -- | -- |
| 3 | 1375 | 225 | 1,03 | -- | -- |
| 4 | 1885 | 197 | 0,94 | -- | -- |
| 5 | 1770 | 268 | 1,20 | -- | -- |
| 6 | 2230 | 222 | 1,04 | -- | -- |
| 7 | 2075 | 328 | 1,42 | -- | -- |
| 8 | 2430 | 269 | 1,17 | -- | -- |

AC centrifugal blower

Dual inlet, forward curved

Specific drawing

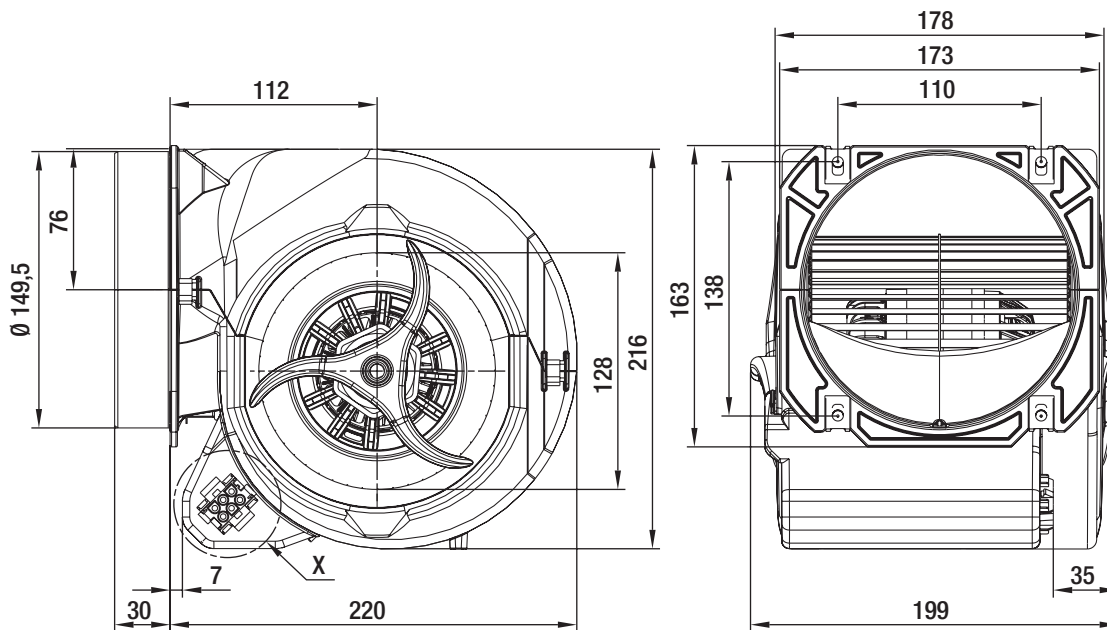

Connection illustration

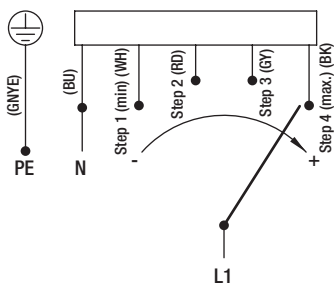

The switch must break the circuit when speed is changed.

Connector pin assignment

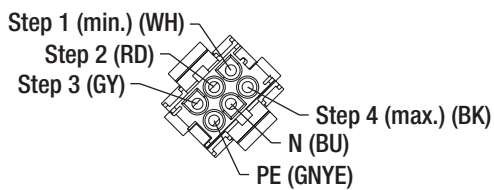

Detail X:
Coded plug system AMP Universal Mate-N-Lok
Connector shell AMP 926 682-3
6x plug pin AMP 926 886-1

AC centrifugal blower

Dual inlet, forward curved

Technical description

- **Impeller material:** Sendzimir galvanized sheet steel
- **Mount:** Via 4 sheet-metal nuts (for threading according to EN ISO 1478-ST4.8), min. screw length 14.5 mm + thickness of mount material
- **Bearings:** Maintenance-free ball bearings
- **Capacitor:** FPU (P2) integrated into the terminal box, completely wired and ready to be plugged in
- **Operating mode:** S1
- **Protection class:** I
- **Approvals:** VDE, CE; UL on request
- **Housing material:** Talcum-reinforced polypropylene, color: black (in accordance with IEC 695 T2-2 and EN 60335-2-31)
- **Design:** 4-stage blower with EW external rotor motor (mounted on both sides using anti-vibration mounting plate) and integrated terminal box
- **Direction of rotation:** Left, looking at connector shell
- **Safety requirements:** In accordance with EN 60335-2-31 with integrated thermal overload protector and integrated FPU (P2) capacitor
- **Insulation class:** "F"
- **System of protection:** IP 20

Contact

ebm-papst Muldingen GmbH & Co. KG

Bachmühle 2
D-74673 Muldingen
Phone +49 (0) 79 38 / 81-0
Fax +49 (0) 79 38 / 81-110
info1@de.ebmpapst.com
www.ebmpapst.com